

# Srikrishna College, Bagula, Nadia, West Bengal



Ref No-

Date: 06.02.2025

## Notice inviting Re-Tender

Rate quotations ( including all taxes) in sealed envelope are invited from authorised Contractors/ Suppliers/Concerns/ Agencies only who have credential, Trade licence, Pan card & GST Registration and Requisite credentials within 14/02/2025 at 2.00 p.m. for following items /articles for Srikrishna College , Bagula, Nadia, West Bengal, India during the Year 2024-2025.

- **Tender-**

1. Rate Quotation for **Selling along with cutting of 24 trees at the College Campus** (The details of the tree are given on the next page).

Sl. No	Item	Quantity	Rate
1.	<b>Selling along with cutting of 24 trees</b>	24 Trees	Per tree/Per CUBE

- **Terms & Conditions:-**

1. It is the responsibility of the purchaser to cut down the trees, and the roots of the trees should be uprooted and cleaned.
2. There should not be any price increase during the Rate Contract.
3. Tenders should be valid for a period of 90 days.
4. If taxes, duties, or any other charges over and above the rates quoted are payable by the purchaser, actual / percentage of such taxes / duties / charges should be clearly indicated.
5. Tenders not complying with the above conditions are liable to be rejected.

Quotation may be submitted within specified date & time positively on working days from 11.00 am to 4pm in the office chamber of the principal.

The authority reserves the right to cancel the order/ refuse the item/articles, in case any variation is found from the original terms and conditions.

Further details of the aforesaid items may be obtained from the office of the undersigned on all working days during working hours.

Sd/  
Principal  
Srikrishna College

*Anita*  
for Principal 07.02.2025  
Srikrishna College  
PO Bagula, Dist Nadia

**SRI SRISHNA COLLEGE**  
**BAGULA, NADIA, WEST BENGAL, INDIA, 741502**  
**MOUZA - BAGULA, J.L.NO - 69, PLOT NO - 633**

Sl no	ITEM DESCRIPTION	QUANTITY	UNIT
1	MAHOGANY		
2	MAHOGANY	1.60 X 5.00 MT.	1
3	MAHOGANY	0.55 X 4.50 MT.	1
4	MAHOGANY	0.70 X 5.00 MT.	1
5	MAHOGANY	0.70 X 3.00 MT.	1
6	MAHOGANY	1.20 X 5.00 MT.	1
7	MAHOGANY	1.30 X 4.00 MT.	1
8	MAHOGANY	1.50 X 6.00 MT.	1
9	MAHOGANY	1.20 X 3.50 MT.	1
10	MAHOGANY	1.00 X 4.00 MT.	1
11	MAHOGANY	1.35 X 4.00 MT.	1
12	MAHOGANY	1.50 X 4.00 MT.	1
13	MAHOGANY	1.45 X 6.00 MT.	1
14	MAHOGANY	1.80 X 4.00 MT.	1
15	MAHOGANY	0.70 X 3.50 MT.	1
16	AILANTHUS	0.90 X 4.00 MT.	1
17	AILANTHUS	2.80 X 5.00 MT.	1
18	AILANTHUS	1.00 X 4.00 MT.	1
19	KADAM	2.60 X 6.00 MT.	1
20	KADAM	1.65 X 4.50 MT.	1
21	JARUL	1.60 X 5.00 MT	1
22	KATHAL	0.90 X 3.00 MT.	1
23	SISOO	1.20 X 3.00 MT.	1
24	COCONUT	0.70 X 3.00 MT.	1
		1.00 X 6 MT.	1
<b>TOTAL CUTTING 24 TREE</b>			

REFERENCE OF PLANTATION AREA OF  
 SRI KRISHNA COLLAGE BAGULA  
 UNDER BAGULA II NO GRAM PANCHAYET  
 MOUZA - = J.L. NO-69 BAGULA  
 POLT NO. - = 633,634  
 KHATIAN NO. - = L.R. 1084  
 P.S. - = HANSKHALI,  
 P.O. - = BAGULA,  
 DIST. - = NADIA  
 PIN - = 741502

*Sukdeb Ghosh* 18.01.2025  
 Dr. Sukdeb Ghosh  
 Principal  
 Srikrishna College  
 Bagula Nadia,  
 W.B. PIN-741502



*Anita*  
 07.02.2025  
 for Principal  
 Srikrishna College  
 P.O. Bagula, Dist Nadia



**SRI KRISHNA COLLAGE BAGULA**  
 MOUZA - BAGULA, J.L. NO. - 69, P.S. - HANSKHALI, DIST - NADIA.  
 SUB TOTAL PLOT AREA  $11.60 + 5.15 = 16.75$  DEC.

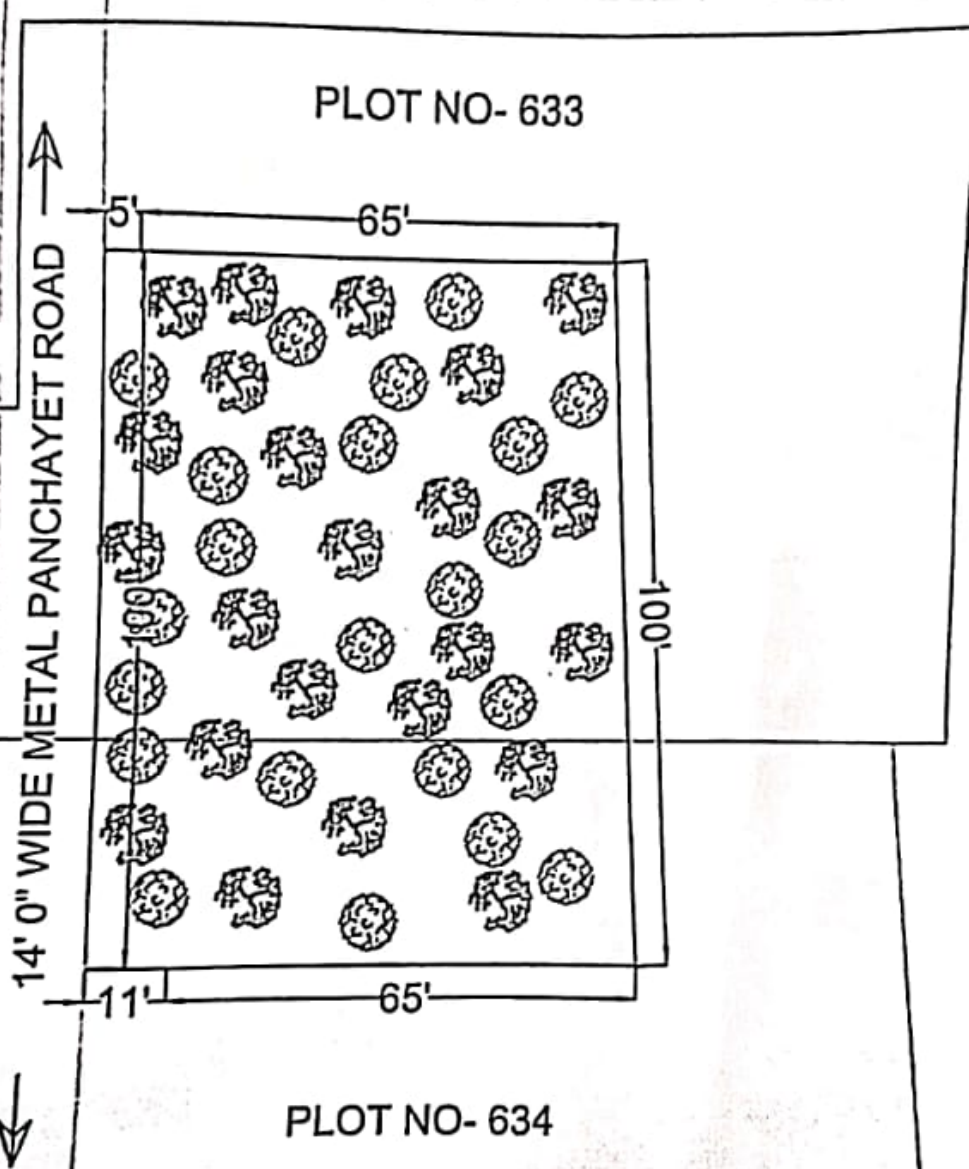

- CUTTING  
24 NO TREE
- MAHOGANY  
15 NO TREE
- AILANTHUS  
3 NO TREE
- KADAM  
2 NO TREE
- JARUL  
1 NO TREE
- KATHAL  
1 NO TREE
- SISOO  
1 NO TREE
- COCONUT  
1 NO TREE



for *Principal*  
 07.02.2025  
 Srikrishna College  
 P.O Bagula, Dist-Nadia

*Dr. Sukdeb Ghosh*  
 Dr. Sukdeb Ghosh  
 Pncipal  
 Srikrishna College  
 Bagula Nadia,  
 W.B. PIN-741502

*18.01.2025*